



START BUILDING YOUR P-51D MUSTANG TODAY WITH THE PARTS IN THIS ISSUE

The parts for your P-51D Mustang will build issue by issue into an incredible 1:18 scale high-quality collector's model. This issue you will be assembling the nose and propellers.



Issue 1 Parts

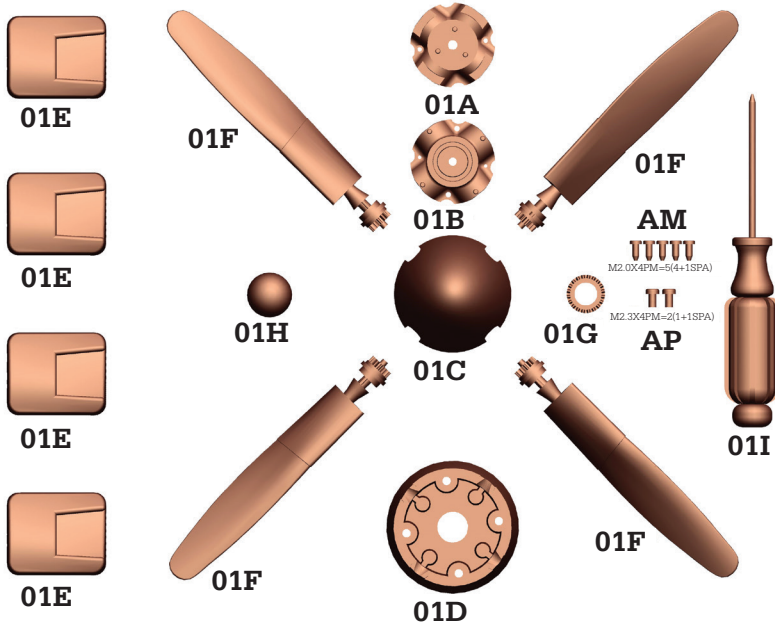

Part Description

PART NO.	ITEMS	DESCRIPTION
01E	4	Propeller blocks
01F	4	Propellers
01G	1	Crown
01A	1	Gearbox, front
01B	1	Gearbox, rear
01D	1	Hub base
01H	1	Dom shell
AM	5	Screws
AP	2	Screws
01C	1	Spinner
01I	1	Screwdriver

Step 1 Setting the gearbox

First find a place in your home which won't be disturbed to work on your model. Either a small dedicated space, or perhaps a tray on which you can keep your parts and move round without losing anything.

To begin, place Part **01G** (the crown) inside the rear part of the gearbox **01B**. Then place both inside the hub base **01D**.

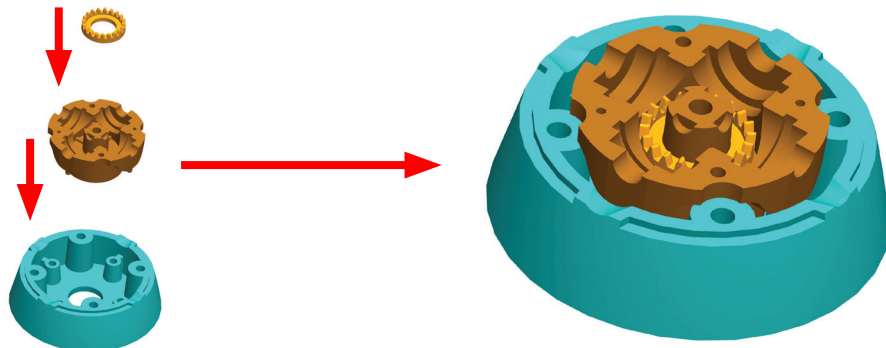



Step 2

Placing the crown

Take the assembled part from Step 1 and carefully arrange the four propeller blocks **01E** around it as shown with the angles below. You are now ready to move onto the Mustang's four propellers.

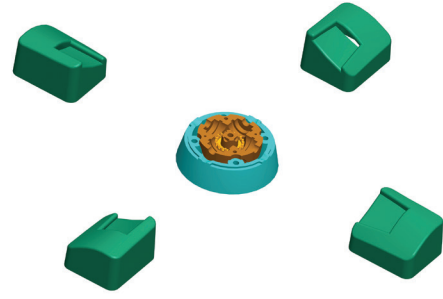

Step 3 First propeller

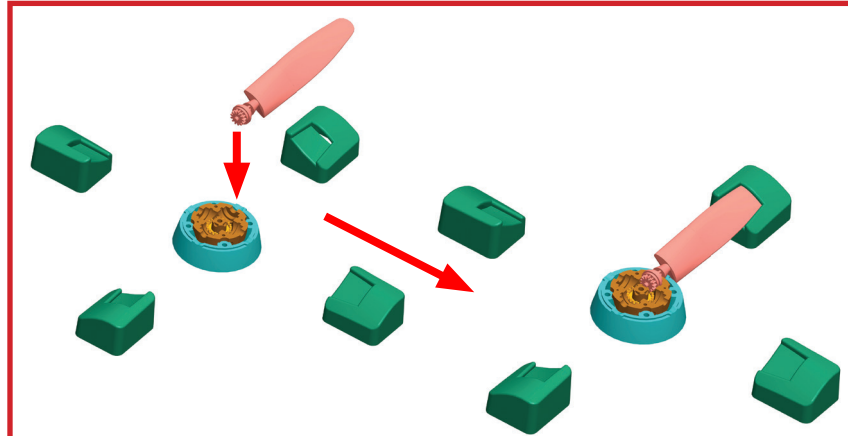

Take one of the four propeller blades **01F** and insert its tip inside the block to ensure the correct angle. The pinion will fit comfortably onto the crown if the angle is as shown in this diagram.

Step 4 Joining the second propeller to the gearbox

Once you have used the correct angle provided by the block to secure the first propeller, move onto the second propeller and fit using the different angle provided by this second block. It is important to make sure that the pinion's 'teeth' match with those of the crown.

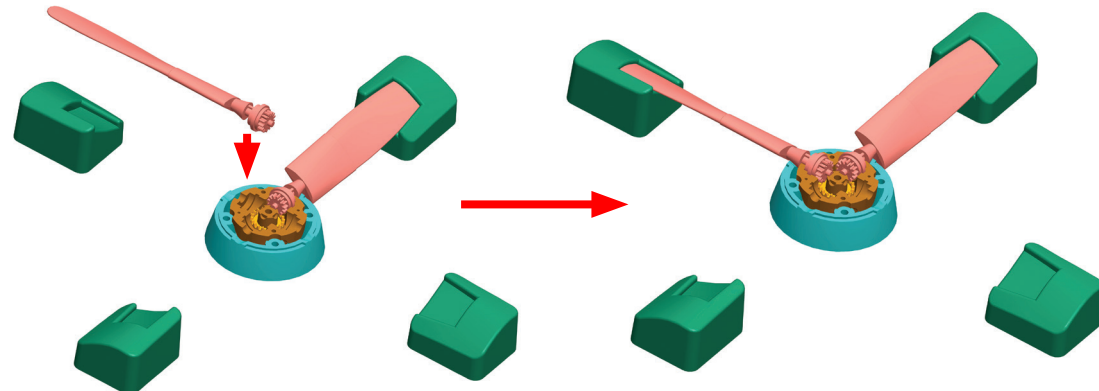

Step 5 Third and fourth propellers

With the pinions fitting snugly, take the third of the Mustang's propellers and place it in position on the crown in the same way. Then complete the job with the fourth propeller.

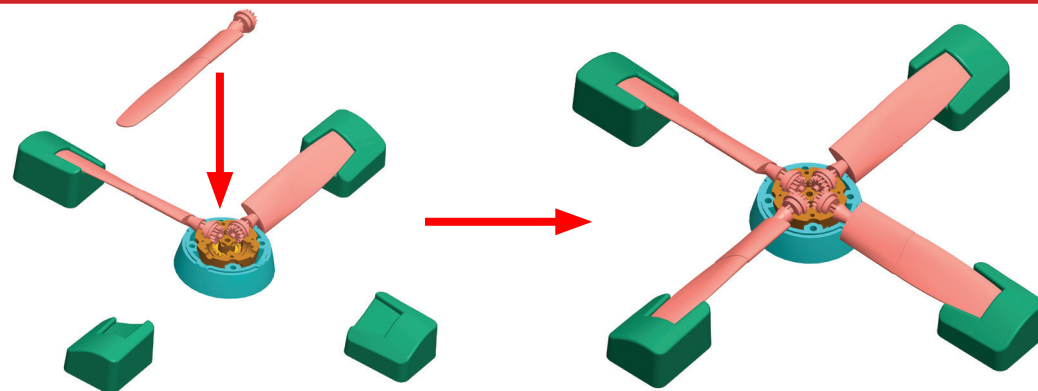

Step 6

Gearbox closing

Now that the propellers are in position and the gears on the pinions and crown gear are matching, you can secure the propeller gear box by attaching the rear part of the gearbox **01A** using one of two **AP** screws and the screwdriver **01I** provided.

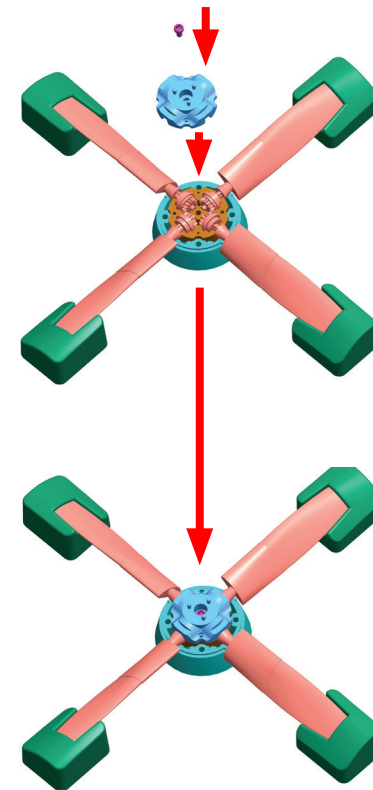

Step 7 Fixing the Dom shell

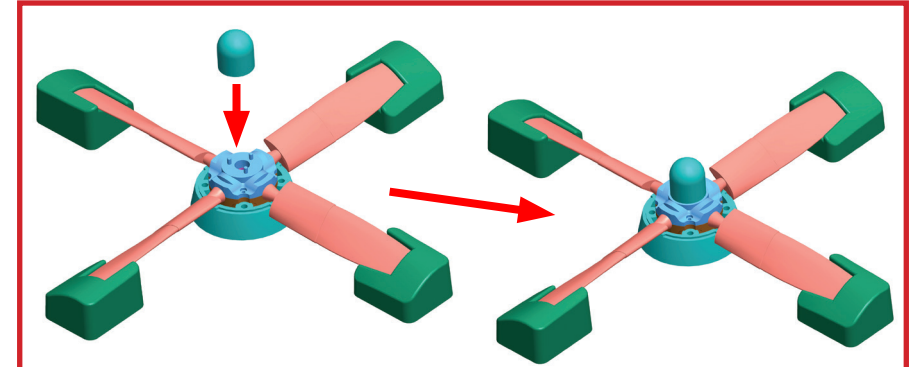

Place the dom shell **01H** carefully onto the three pins of the completed hub and fix it using glue.

Step 8 Inserting the Spinner

Carefully line up the four hollows of the spinner **01H** onto each of the four propellers and lower the spinner onto the dom.

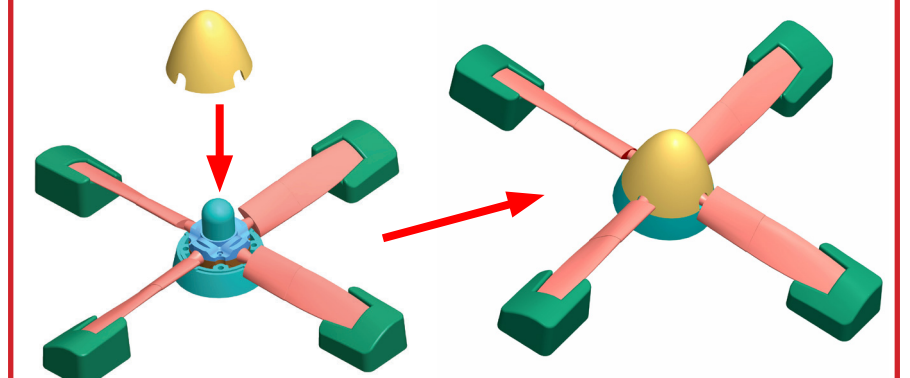

Step 9 Tightening the spinner and complete!

Turn the completed unit upside down carefully and keep the spinner tight by inserting four of the **01H** screws provided into the holes. When tightened turn the unit around and put to one side ready for the next part of the Mustang build.

